

1506 3438 Sawmill Crescent, Vancouver

\$856,900



MODE presents this 890sqft North West 2bdrm +flex,2bath home in River District (RD) Vancouver. MODE is one of the tallest concrete highrises in RD, equipped w/ premium appliances; gas range, walloven&built-in microwave, fully integrated fridge&dishwasher, and quartz countertop and backsplash. Well though out layout with bedroom separation, energy-efficient in-floor heating in master ensuite, and high efficiency heating and cooling system. MODE is steps from Town Centre retailers & lush green space a long w/ outstanding onsite amenities including hot tub,daytime concierge, work hub, theatre room, and two guest suites. Come see Vancouver's last waterfront community, still at Vancouver's absolute best value. Sales Centre open daily 11am-4pm. Move in Late Summer 2022.

KEY INFORMATION

MLS® R2541548

Residential Attached

South Marine

2 Bedrooms

2 Bathrooms

890 SF

\$359.52 Maintenance Fees

FEATURES

Year Built: 2022

Listed By: Wesgroup Realty Ltd.

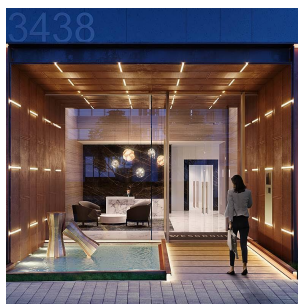
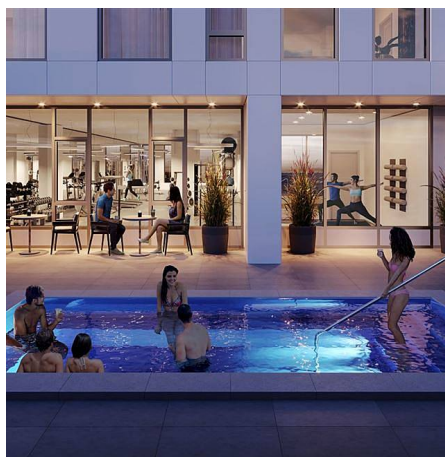

rennie