

11983 Hall Street, Maple Ridge

\$1,100,000

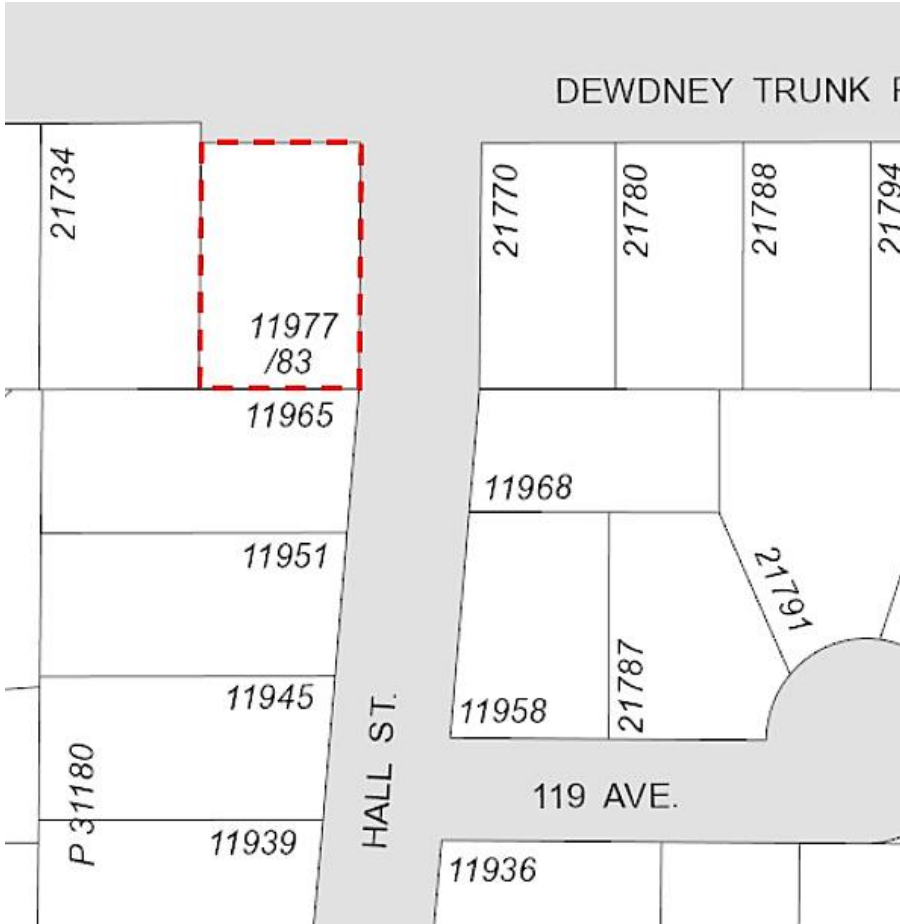

ATTENTION! Developer Alert! Investor Alert!
LAND ASSEMBLY. For development or investment, rarely found land assembly opportunity with Urban Major Corridor Residential OCP. Potential to develop into townhouses or low rise buildings. Transit Corridor Multi-Family under the Lougheed Transit Corridor Plan which may allow for up to 2.5 FSR. Please check with the City of Maple Ridge. Well maintained duplex with spacious rooms. Located near schools, parks, and Downtown Maple Ridge. Easy access to transit and highway. DO NOT ENTER THE PROPERTY WITHOUT APPOINTMENT. Purchaser must purchase both ½ duplex, 11983 & 11977 Hall Street.

KEY INFORMATION

MLS® R2517981
Residential Attached
West Central
3 Bedrooms
2 Bathrooms
1,445 SF

FEATURES

Year Built: 1998
Listed By: Zolo Realty